

Project Profile

Lancaster University Phase 4 | Lancaster

Client	Lancaster University
Client Sector	Education
Project Value	£28,900,000
Services Provided	Pre and Post Contract Financial Close Out Services
Project Size	
Architect	
Contractors	

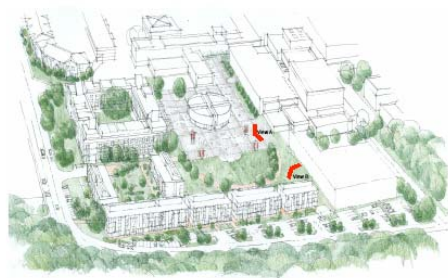

The project comprises of the demolition of existing structures and the construction of residential houses, and is located on two sites within the University of Lancaster. The works at the County College comprises of the construction of 346 residential and disabled units and the refurbishment of common areas and 184 rooms. The works at the Grisdale College comprises of the construction of 453 residential and disabled units.

Rider Levett Bucknall are employed to provide technical advice in project cost control, benchmark costs, cost estimates, whole life cycle costs, tender documents, value engineering, procurement of packages, valuations, cash flow forecast and final accounts.

The works commenced on site in August 2006 with completion of the scheme expected in November 2007.